

HDC6M

50m CAT5E/6 HDMI EXTENDER WITH HDMI LOOP-OUT & POWER OVER CABLE

TRANSMITTER + RECEIVER



The easiest way to extend your 1080p HDMI & IR via a single CAT5e/6 cable!
The HDC6M is a super compact & easily mountable HDMI extender, with local HDMI loop out, IR and power over cable. It's a great option when space is limited.

- Transmits 1080p HDMI Audio/Video Signals and IR over a 50m single solid CAT5e/6 cable
- Single power supply to send power via the transmitter to the receiver unit
- Audio sampling rate up to 48KHz, supports 7.1 channels
- Supports Dolby True-HD, DTS-HD Master audio
- DIP switch to set network cable distance
- HDCP compliant

SPECIFICATIONS

Transmission Distance	1080p60Hz @ YUV 4:4:4 up to 50m*
Operating Temperature Range	-5 to +40°C
Operating Humidity Range	5 to 90% RH (No Condensation)
Resolution Outputs	1080p/1080i/720p/576p/480p
Audio Formats Supported	DTS-HD Master Audio, Dolby True HD, multi-channel 7.1, stereo etc
Dimensions (HxWxD) / Net Weight	16.5 x 68 x 79.3mm / TX: 120g, RX: 115g
Power Consumption	2W (Max.)

MODEL: HDC6M

CODE: 07351052

WARRANTY: 12 months



INCLUDES

- 1x HDMI Transmitter
- 1x HDMI Receiver
- 1x IR TX Emitter
- 1x IR RX Receiver
- 1x 12V/ 1A DC Adapter (Australian approval)
- User Manual

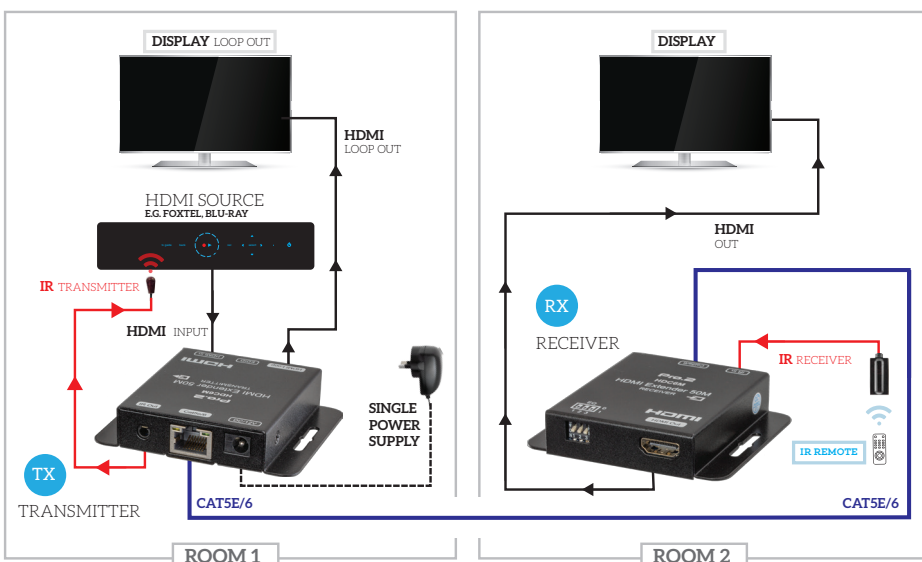

*PLEASE NOTE:

50m distance is under perfect transmission conditions including straight cable runs with no bends, kinks, electrical interference, patch panels or wall outlets. Use CAT6 solid core cable for best results.