



## Operating Manual

### OVERVIEW

The Redback A 4116 stereo amplifier is super compact and ideally suited to smaller PA system installations. Designed around the ST TDA7492 IC it offers virtual “destruction proof” operation even under sever misuse such as over voltage, over temperature, over load and short circuit speaker line conditions. The unit will automatically shut down when overloaded and will restore to normal operation when the fault condition is removed. The A 4116 can be used as a stand alone/ bench mount amplifier or can be rack mounted when used in conjunction with optional hardware (H 4990).

### FEATURES

- 15W RMS Output into an 8Ω load
- 1 Stereo RCA input
- 1 Music input (3.5mm)
- 1 Line/Sub output
- 4-16Ω output
- 24V DC operation

### CONNECTIONS

Figure 1: Front Panel Layout

- 1) 3.5mm Input
- 2) Treble Control
- 3) Bass Control
- 4) Volume Control
- 5) Fault Indicator
- 6) Power Indicator
- 7) Power Switch

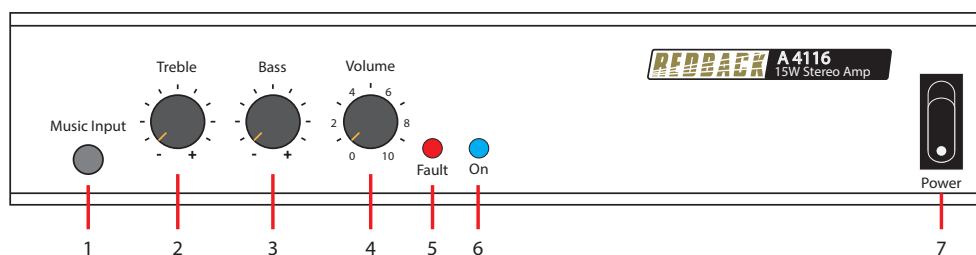
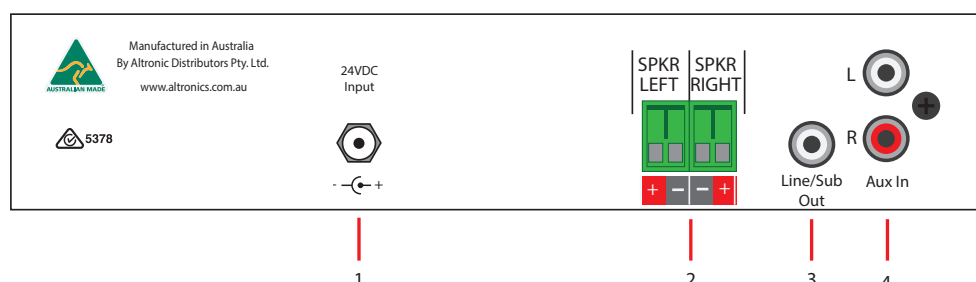

Figure 2: Rear Panel Layout

- 1) 24V DC Power Input
- 2) Speaker Connection
- 3) Line/Sub output
- 4) Auxilliary Input



# Redback® A 4116 15W Stereo Amplifier

Figure 3: Connection Diagram

The figure below illustrates a typical installation.

Note: The Aux input will be disconnected when a source is connected to the 3.5mm music input on the front panel.

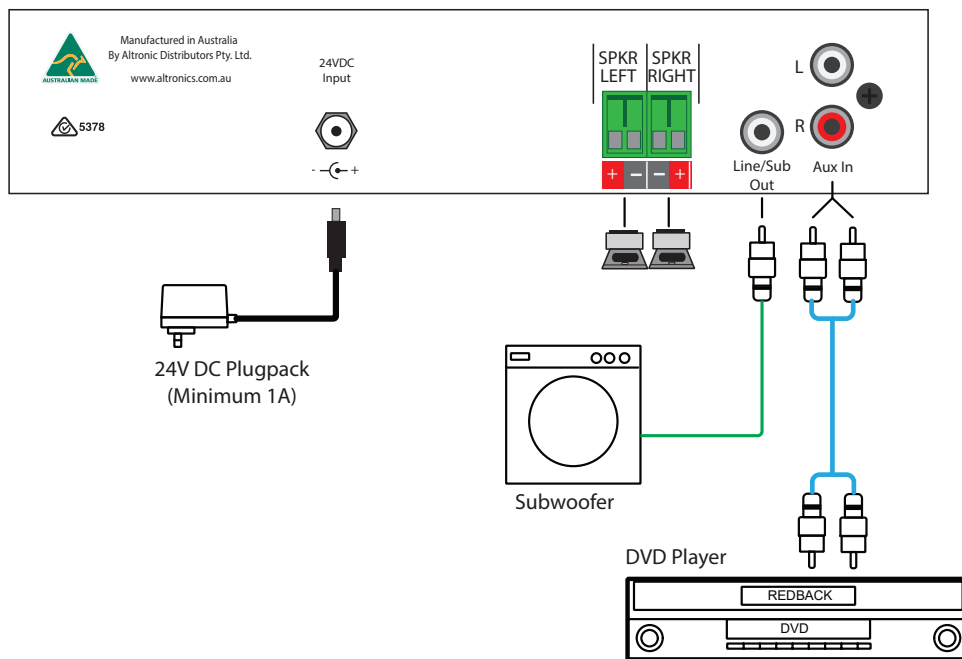

## TROUBLE SHOOTING

### DISTORTED OUTPUT

Check that the speaker type is correct for the output that you are using. Check for any short circuits on the speaker line.

### VERY LOW OUTPUT

Make sure that the input is the correct level (check for shorted connectors). Check for any short circuits on the speaker line.

### AMPLIFIER KEEPS ON CUTTING IN & OUT

Check speaker types, ratings and for any short circuits on the speaker line.

## SPECIFICATIONS

**Power Output:** .....15 watts RMS into 8Ω

**Distortion:** .....< 3% @ 1kHz

**Signal to Noise Ratio:** ..Typically 75dB below rated output

### Frequency Response

**Aux input:** .....60Hz - 15kHz, -3dB

**Music Input:** .....1V

**Aux Input:**.....1V

### Output Connectors

**Speakers:** .....Screw terminals

**Output impedance:** .....4-16Ω

### Input Connectors

**Aux input:**.....RCA stereo socket

**Music input:**.....3.5mm socket

**24V DC power:** .....2.1mm DC Jack connector

**Controls:** .....Volume, Bass, Treble, ON/OFF switch

**Indicators:** .....Fault, Power

### MISC.

**Power supply:**.....24V DC

**Weight:** .....≈0.5kg

**Dimensions:**.....≈210W x 140D x 44H mm

**Colour:** .....Black

**DC Protection:** ..... Internal 2A 3AG Fuse

\*Specifications subject to change without notice

All Australian made Redback products are covered by a 10 year warranty.

Should a product become faulty please contact us to obtain a return authorisation number. Please ensure you have all the relevant documentation on hand. We do not accept unauthorised returns. Proof of purchase is required so please retain your invoice.