

2 x 50W Bluetooth Amplifier

Operating Instructions



Features

- Class-D 2 x 50W amplifier
- Bluetooth 4.2 wireless streaming
- Stereo RCA & 3.5mm jack inputs
- Optical input with high performance DAC
- Automatic signal switching with priority for Bluetooth audio source
- 240V AC operation

A 4860 2 x 50W Bluetooth Amplifier

Introduction

This 50W bluetooth stereo amplifier provides clean Class D power with compact and a lightweight design. It features Bluetooth 4.2 streaming with in-built optical input for digital audio sources. The amplifier is also fitted with 3.5mm stereo jack and stereo RCA inputs for connection to external audio sources. Bluetooth takes priority over all other inputs, providing easy wireless streaming when you need it. The 2 x 50W RMS output is ideal for small retail environments. It is perfectly paired with the A 4861 subwoofer amplifier and C 1065 ceiling mount subwoofer for added musical performance.

Specifications

| | |
|---------------------------------|--------------------------------|
| Power Output | 25WX2 (RMS @ 8Ω) |
| Power Output | 50WX2 (RMS @ 4Ω) |
| Total Harmonic Distortion (THD) | <1%(Rated power: 50W @ 4Ω) |
| Signal to Noise | >92 dB A WTD |
| Frequency Response | 20Hz~20KHz +0/-2dB @ -3dB |
| Sub Out Frequency | 100Hz/1V |
| Line Level Input Sensitivity | 700mV |
| Channel Separation | 50dB |
| Bluetooth | 4.2 |
| Protection | Overload , Speaker Short |
| Dimension | 200mm x125mm x 47.5mm (WxDxH), |
| Weight | 0.6kg |

Safety Instructions

- Do not expose this unit to water, moisture, or excessive humidity.
- Do not install or place this unit in a built-in cabinet, or other confined space without adequate ventilation.
- To prevent risk of electrical shock or fire hazard, due to overheating do not obstruct unit's ventilation openings.
- Do not install near any source of heat including other units that may produce heat.
- Do not place unit near flames.
- Only clean unit with a dry cloth.
- Unplug unit during lightning storms or when not used for an extended period of time. A surge protector is strongly recommended.
- Protect the power cord from being walked on or pinched particularly at the plugs.
- Use unit only with accessories specified by the manufacturer.
- Refer all servicing to qualified personnel.

CAUTION

TO REDUCE THE RISK OF ELECTRIC SHOCK, DO NOT REMOVE COVER (OR BACK). NO USER-SERVICEABLE PARTS INSIDE. REFER SERVICING TO QUALIFIED SERVICE PERSONAL.

A 4860 2 x 50W Bluetooth Amplifier

Connection Diagram

A 4860 as a standalone stereo speaker amplifier

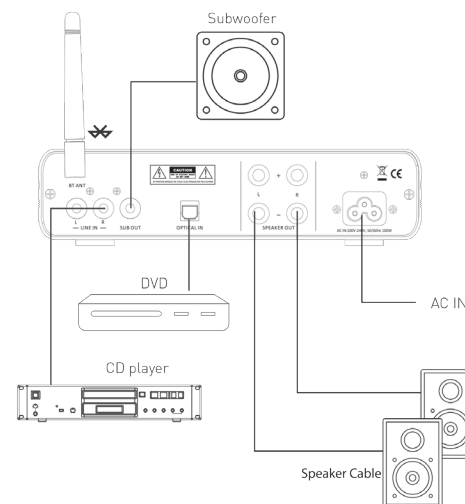

Connection Diagram - A 4860 to A 4861

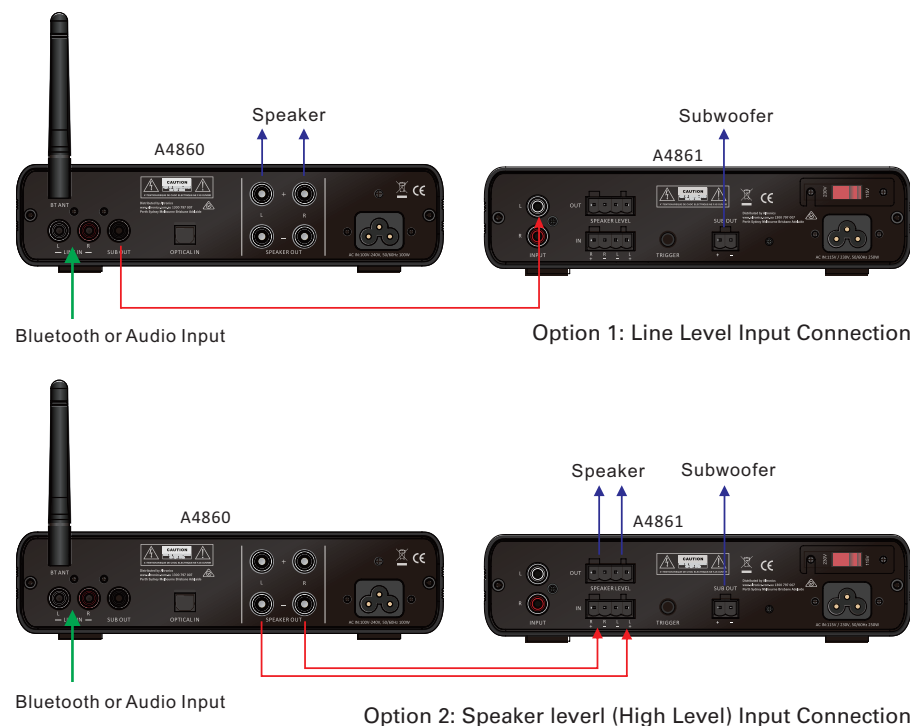

Front Panel

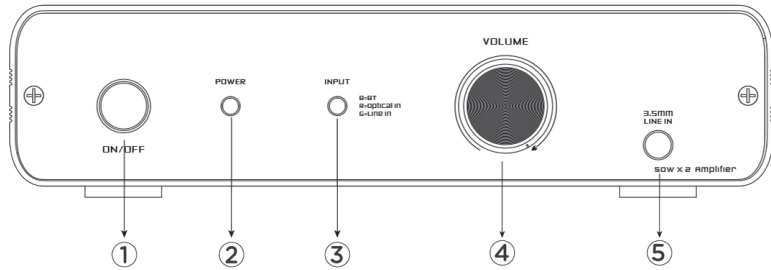

1. Power Switch: The front panel switch will manually turn the power on or off.
2. Power LED: Red - Standby / Protection. Green - The amplifier is in working status.
3. Input Source Indicator: Blue - Bluetooth Red - Optical In Green: Line In (RCA or 3.5mm)
4. Volume: Adjust the output level.
5. Line In: 3.5mm Audio input jack, accepts the audio signal from smartphone, tablet, MP3 player or other device.

NOTE: When audio device is plugged into this 3.5mm input jack, the RCA input jacks on rear panel are disconnected.

NOTE: For Bluetooth pairing, turn on the amplifier, and ensure your device has Bluetooth enabled. Connect the device to amplifier directly and begin audio playback in your device. The bluetooth recognition ID is A4860.

Rear Panel

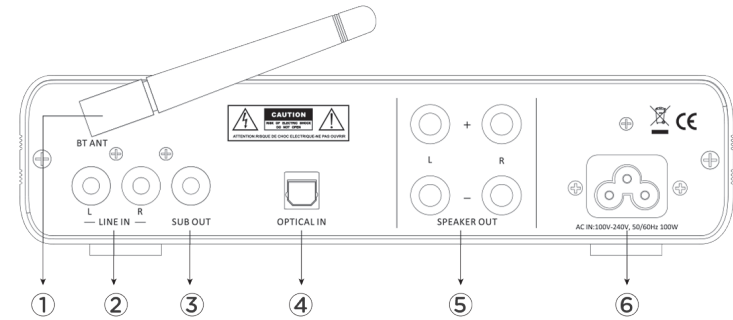

1. Antenna: For a wireless Bluetooth connection.
2. RCA inputs: For connecting to audio devices equipped with analog output.
3. Sub Out: For connecting to a subwoofer amplifier or active subwoofer speaker.
4. Optical In: For connecting to audio devices equipped with digital optical output.
5. Speaker Output: For connection to speakers.
6. AC Power In: For connecting the power cord.